

REV.	Description	REV.	Description
0.0	首次发行 史亚萍 2021/02/26		
0.1	增加SOC补充说明 史亚萍 2021/05/24		
0.2	配件包螺钉改为自攻螺钉， 取消底座与从控直接的螺丝连接 俞小莉 2021/09/01		

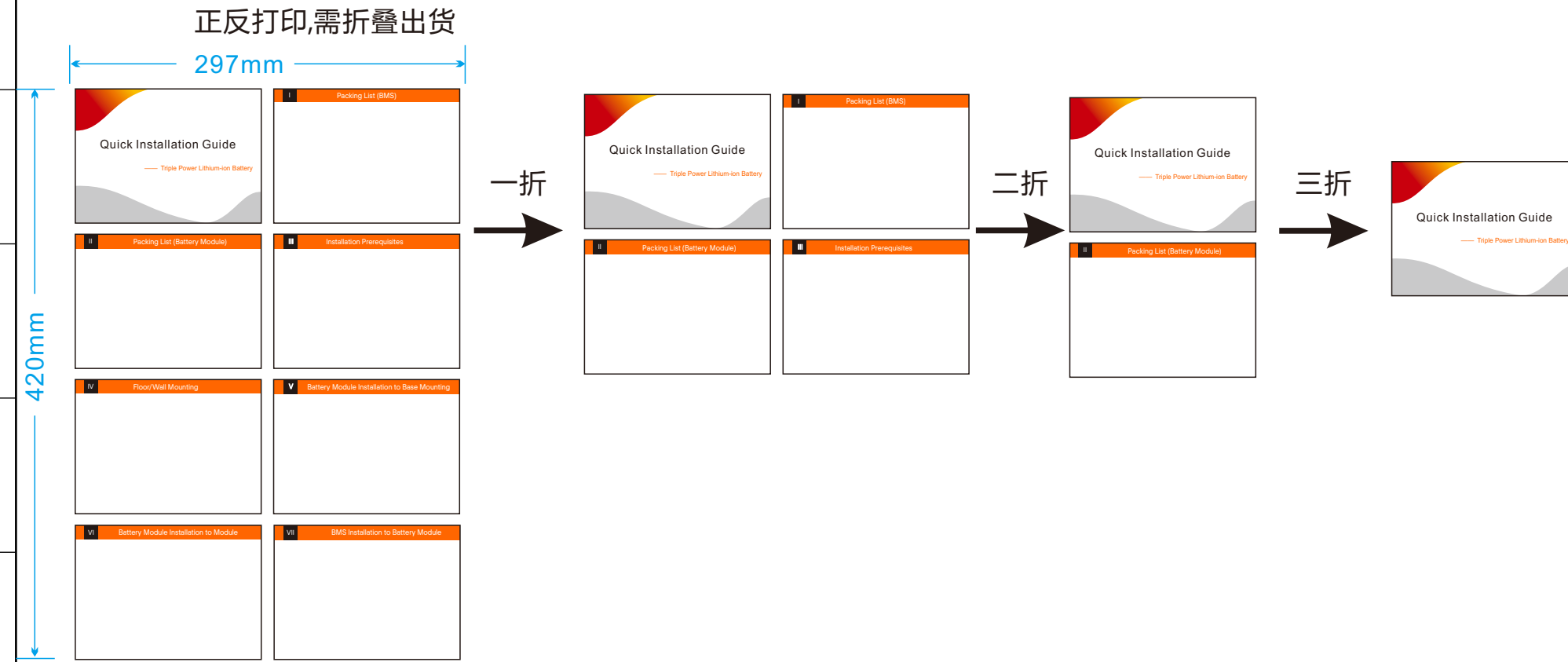

- 技术要求:
- 1.材质为80g双胶纸, 所有页彩色打印, 正反打印
 - 2.未注尺寸公差按 $\pm 1.5\text{mm}$
 - 3.图面、字体印刷清晰、无毛边、不起边、油墨不脱落
 - 4.字体颜色为PANTONE Black C, 无边框, 底色为白色
 - 5.符合RoHS要求

描述	安装说明书 Triple Power 3.0 英文 SOLAX		设计	史亚萍	2021/02/26
			审核	葛久远	2021/02/26
材料	双胶纸		核准	葛久远	2021/02/26
料号	614.00520.02		浙江艾罗网络能源技术有限公司		
单位	mm	页次			

描述	安装说明书 Triple Power 3.0 英文 SOLAX			浙江艾罗网络能源技术有限公司 SolaX Power Network Technology (Zhe jiang) Co.,Ltd.
料号	614.00520.02			
单位	mm	页次		

Quick Installation Guide

— Triple Power Lithium-ion Battery

I Packing List (BMS)

Note: The Quick Installation Guide briefly describes required installation steps. If you have any questions, refer to the User Manual enclosed with the BMS for more detailed information.

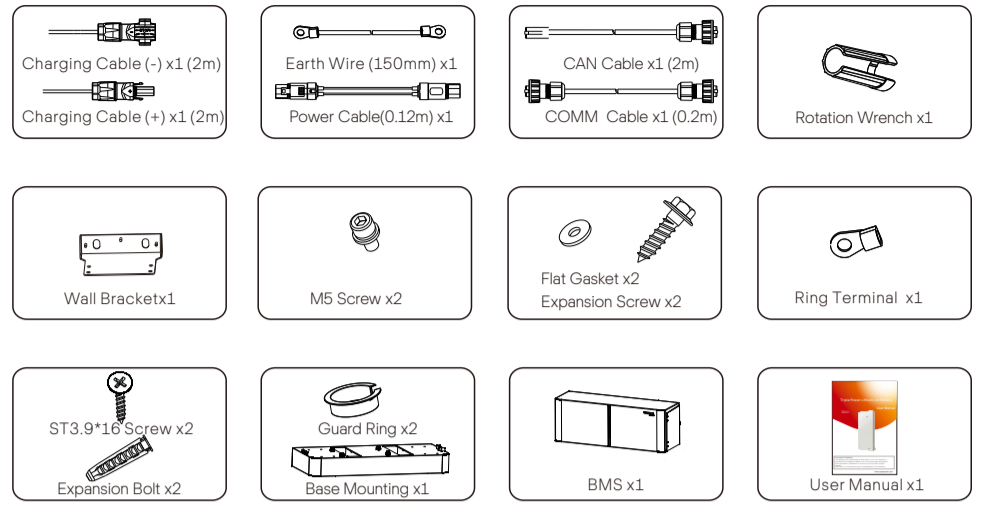

II Packing List (Battery Module)

One Battery Module (HV10230 x1):

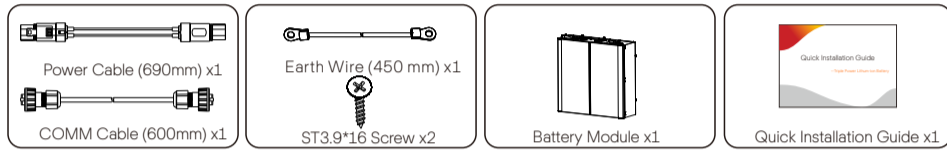

Accessories (1) of the three and four Battery Modules (HV10230x3/4):

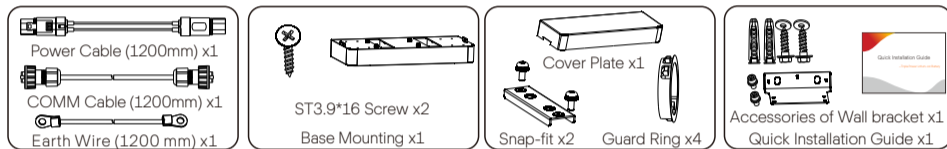

Accessories (2) of the three and four Battery Modules (HV10230x3/4):

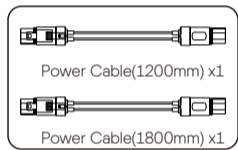

Note: The two power cables need to be purchased separately

III Installation Prerequisites

Ensure that the installation location meets the following conditions:

- The building is designed to withstand earthquakes
 - The location is far from the sea to avoid salt water and humidity, over 1000m
 - The floor is flat and level
 - There are no flammable or explosive materials, at a minimum of 0.9m
 - The ambience is shady and cool, away from heat and direct sunlight
 - The temperature and humidity remain at a constant level
 - There is minimal dust and dirt in area
 - There are no corrosive gases present, including ammonia and acid vapor
 - Where charging and discharging, the ambient temperature ranges from 0°C to 45°C
- In practice, the requirements of battery installation may be different due to environment and locations. In that case, follow up the exact requirements of the local laws and standards.

- NOTE!**
The Triple Power battery module is rated at IP65 and thus can be installed outdoors as well as indoors. However, if installed outdoors, do not allow the battery pack to be exposed to direct sunlight and moisture.
- NOTE!**
If the ambient temperature exceeds the operating range, the battery pack will stop operating to protect itself. The optimal temperature range for operation is -10°C to 50°C. Frequent exposure to harsh temperatures may deteriorate the performance and lifetime of the battery module.
- NOTE!**
When installing the battery for the first time, the manufacturing date between battery modules should not exceed 3 months.

IV Floor/Wall Mounting

Make sure the wall is strong enough to withstand the weight of battery.

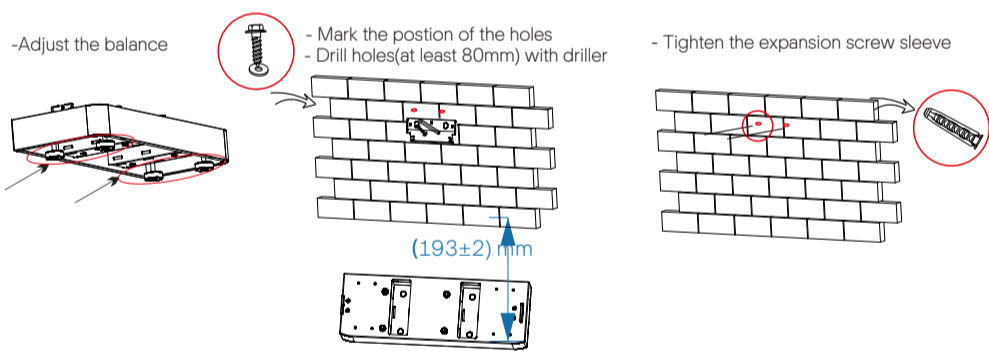

V Battery Module Installation to Base Mounting

Step 3: Match the battery with base mounting
Place the BMS on top of the battery module. Ensure that the BMS and battery unit align on matching sides as shown in the diagram below.

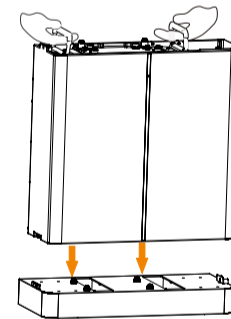

VI Battery Module Installation to Module

For two battery modules:

Place the second one on top of the module and two sides are locked with screws. Fix the battery module and wall bracket with expansion bolts.

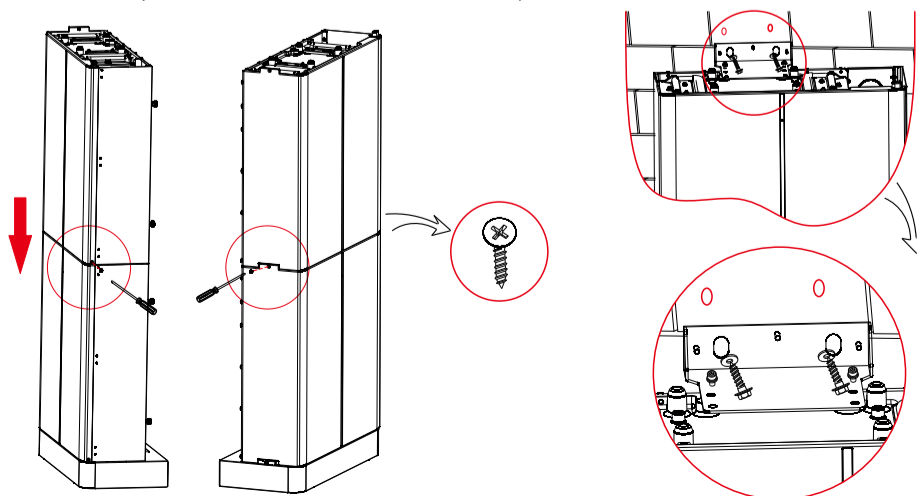

Note: One battery module or connected to the BMS, need to be installed a bracket to fix.

VII BMS Installation to Battery Module

Match the BMS to the battery modules

Place the BMS on top of the module and two sides are locked with screws(N).

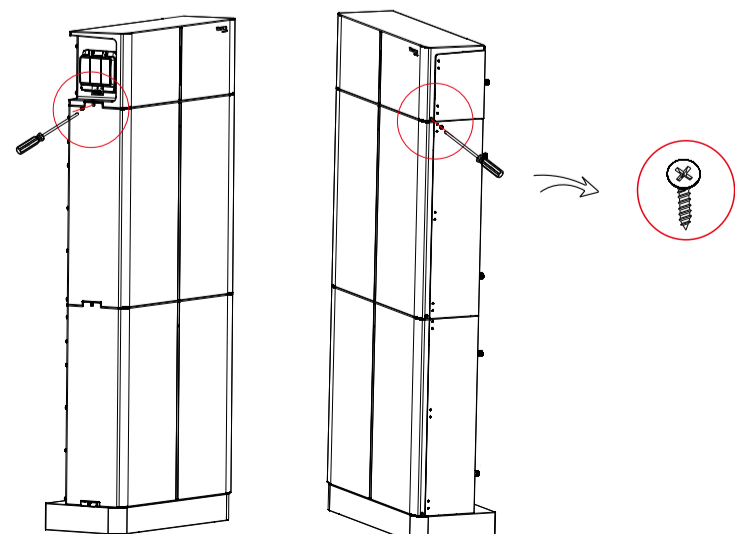

BMS to Inverter:
 BAT+ to BAT+(A:2m),
 BAT- to BAT-(B:2m),
 CAN to CAN(D:2m)

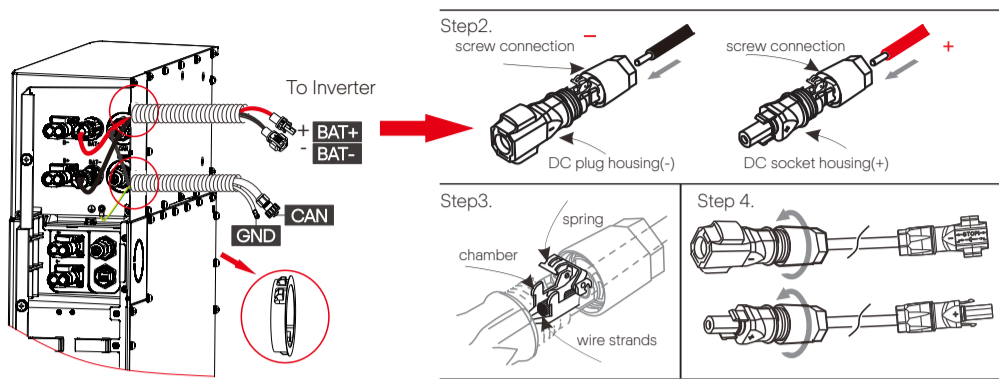

Ensure that both ends of the cables are connected to the correct connector, which are on the right side of the BMS and battery module.

- BMS to Slave1: B+ to B+(C:1200mm), B- to B-(A1:690mm), COMM to COMM1(E:200mm)
- The BMS and battery modules need to be grounded.

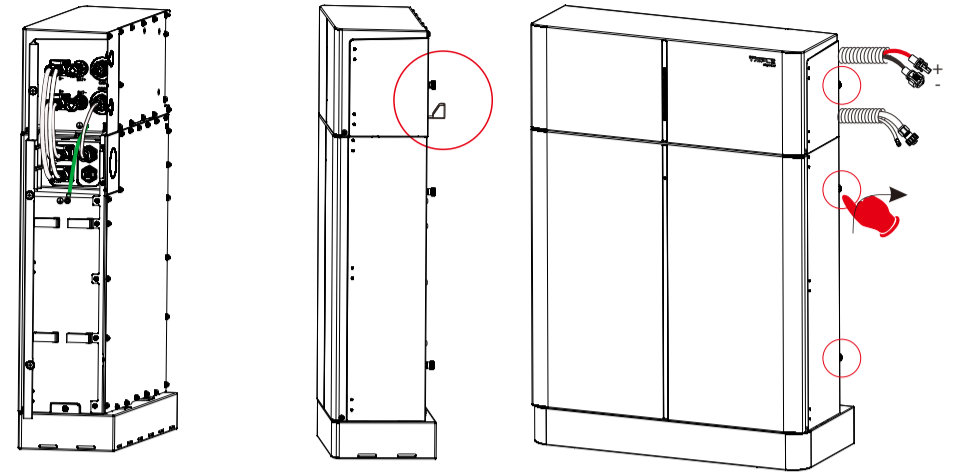

Install a fixed wall bracket on the battery module, and then check to make sure the connections are securely locked.

BMS to Slave1:
 B+ to B+ (C:120mm);
 COMM to COMM1 (E:0.2m)

BMS to Slave2:
 B- to B- (A1:690mm)

Slave1 to Slave2:
 B- to B+ (A1:690mm); COMM2 to
 COMM1 (B1:600mm)

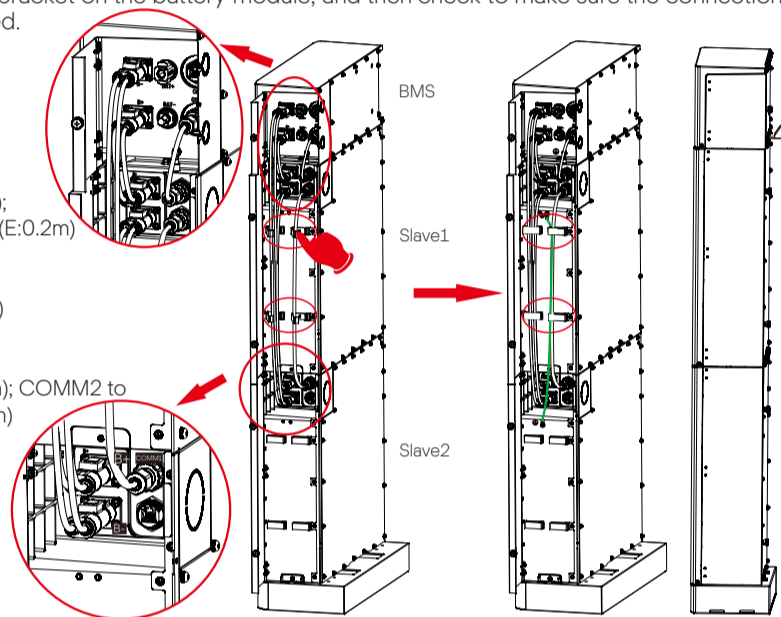

Install a fixed wall bracket on the battery modules and the cover plate of the third battery module.

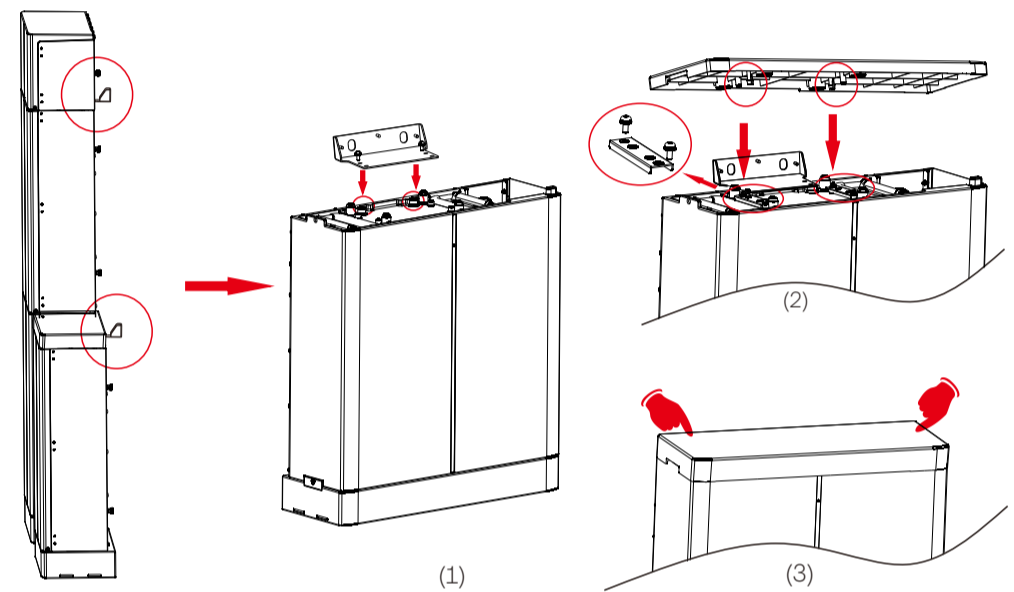

The BMS and battery modules need to be grounded.
 Between battery modules need to be grounded.

BMS to Slave1:
 B+ to B+ (C:120mm); COMM to
 COMM1 (E:200mm);

BMS to Slave3:
 B- to B- (A1:1.8m); Get the cables
 through corrugate pipe.

Slave1 to Slave2:
 B- to B+ (A1:690mm); COMM2 to
 COMM1 (B1:600mm)

Slave2 to Slave3:
 B- to B+ (A2:1.2m); COMM2 to COMM1
 (B2:1.2m); Get the cables through
 corrugate pipe.

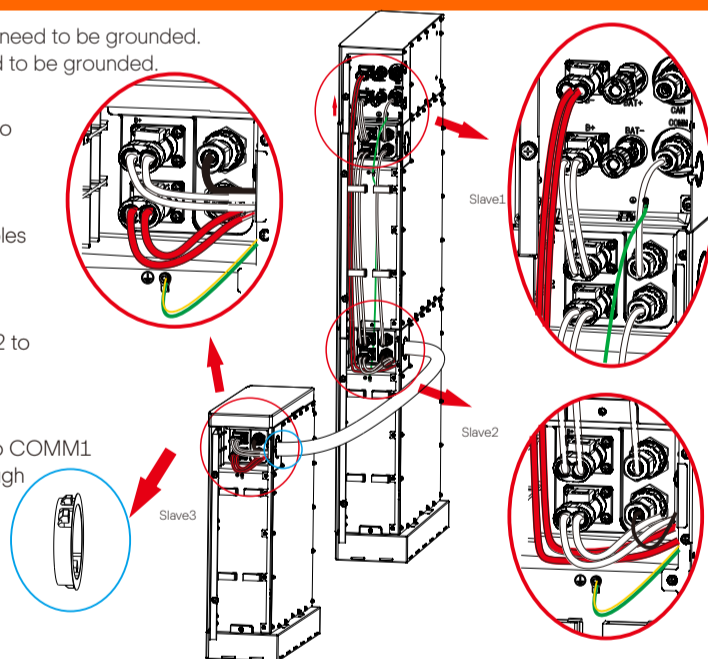

Install the fixed wall brackets on the battery modules
 And then check to make sure the connections are securely locked.

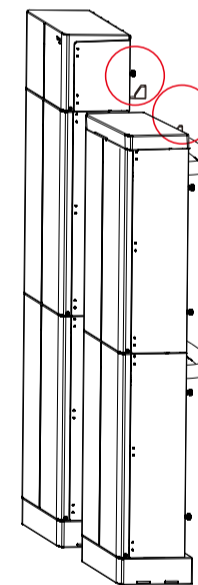

BMS to Slave1:
 B+ to B+ (C:120mm);COMM to COMM1 (E:200mm);

BMS to Slave4:
 B- to B- (A3:1.2m), Get the cable through corrugate pipe.
 Slave1 to Slave2:
 B- to B+ (A1:690mm);COMM2 to COMM1 (B1:600mm);

Slave2 to Slave3:
 B- to B+ (A3:1.2m);COMM2 to COMM1 (B2:1.2m);

Slave3 to Slave4:
 B- to B+ (A1:690mm) and COMM2 to COMM1
 (B2:1.2m).
 Get the cables through corrugate pipe.

The BMS and battery modules need to be grounded.
 Between battery modules need to be grounded.

The two ends of the corrugated
 pipe need to be protected with guard rings.

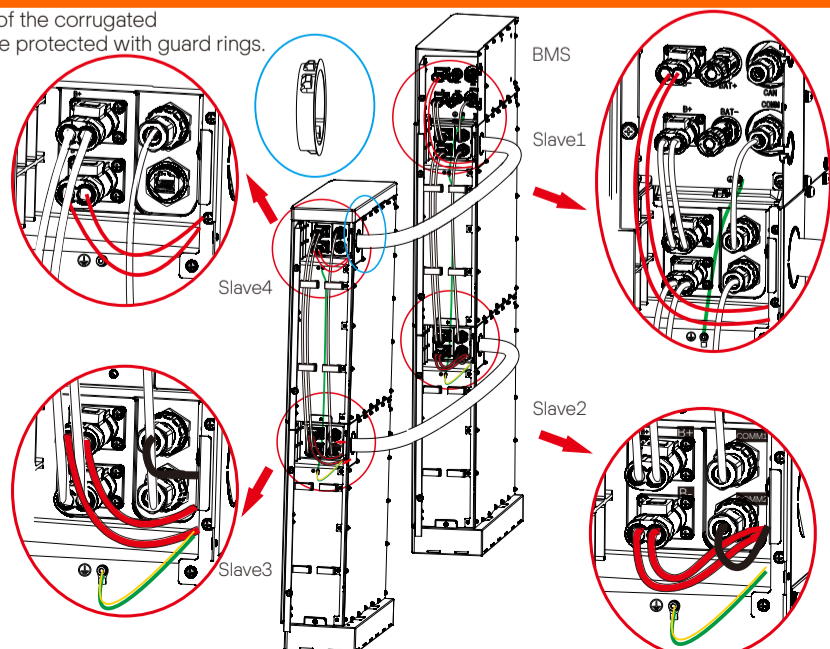

If all batteries are used for the installation, follow these steps for beginning operation.

Verify the model number of each battery module to ensure that they are all the same model.

Once all battery module(s) are installed, follow these steps for beginning operation:

- 1) Open the cover board of the BMS
- 2) Move the circuit breaker switch to the ON position
- 3) Press the POWER button to turn on the T-BAT system
- 4) Turn on the AC switch of inverter

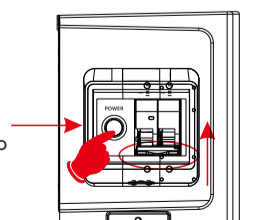

-If the battery is not used for more than 9 months, the battery must be charged to at least SOC 50 % each time.

-When installing the battery for the first time, the manufacturing date between battery modules should not exceed 3 months.

-If the battery is replaced, the SOC between the batteries used should be as consistent as possible, with a maximum difference of ±5 %.

-If you want to expand your battery system capacity, please make sure your existing system capacity's SOC is about 40%. The expansion battery is required to be manufactured within 6 months; If more than 6 months, recharge the battery module to about 40%.